



شركة السند لمعدات الإطفاء والسلامة العامة
ALSANAD FIREFIGHTING & SAFETY EQUIPMENT



Fire
Cabinets
SN700

SINGLE COMPARTMENT FOR
SEMI-RIGID FIRE HOSE REEL

- ❖ Recessed type cabinets
- ❖ Semi-Recessed type cabinets
- ❖ Surface type cabinets
- ❖ Self Stand type cabinets



Model: SN700

Fire Cabinet is engineered with a smart dual-compartment configuration that seamlessly combines efficiency, versatility, and ease of access. One vertical compartment is dedicated to a semi-rigid fire hose reel, to accommodate fire extinguishers professional appearance, the cabinet delivers a complete, reliable, and highly visible fire protection solution suitable for a wide range of commercial, industrial, and public environments.

- ❖ Cabinets are manufactured from Mild Steel or Stainless Steel material with a thickness of 0.9mm to 2.0mm which depends on usage or customer request.
- ❖ Back box, Door and Frame can be of different thickness and material.
- ❖ The cabinets are available with all around folded edges without any sharp edges.
- ❖ Optional Hairline or Mirror finish Stainless Steel cabinets are also available.
- ❖ Cabinets are painted with Powder Coated for elegant finish and protection from rust.
- ❖ Operation Instructions are silk screen printed in Arabic and English languages inside the cabinet.
- ❖ Hose Reels in cabinets are fully equipped with landing valves and nozzles.
- ❖ Cabinets are available in different size and design to meet architectural requirements.
- ❖ Cabinets can be surface mounted, recessed or semi-recessed types.

- ❖ Hinges are available with Piano type / Bush Pin Hinges / Concealed Pin Hinges as per requirement.
- ❖ Pressure Reducing Valve or Lock Shield Valve are available upon request.

Item	Specification
Body Material	Mild Steel
Body Material	Stainless Steel #304
Thickness	0.9mm / 1mm / 1.2 mm / 1.5 mm / 2.0mm
Mounting Type	Wall Mounted (Recessed / Surface / Semi-Recessed)
Finish	Red Powder Coated (RAL 3000)
Markings	Operation instructions printed on the door

- ❖ Other material types are available upon request.
- ❖ Cabinets in stainless steel are available with hairline or mirror finish as per customer request.

Fire Cabinets



Fire Hose Reel : 25mm ϕ x 30 meter

Jet & Spray Nozzle : 1"

Landing Valve : 1"

Fire Extinguisher : 5 Kg CO2

Fire Extinguisher : 6 Kg Dry Powder

MODEL	WIDTH (W)	HEIGHT (H)	DEPTH (D)
SN700	800	1600	250
SN700S	800	1600	250
SN710	750	1500	230
SN710S	750	1500	230
SN720	730	1450	230

All dimensions are in mm.

Note: The dimensions are for the back box only. In case of recessed or semi-recessed cabinets, the frame size will be added on top of the back box size.

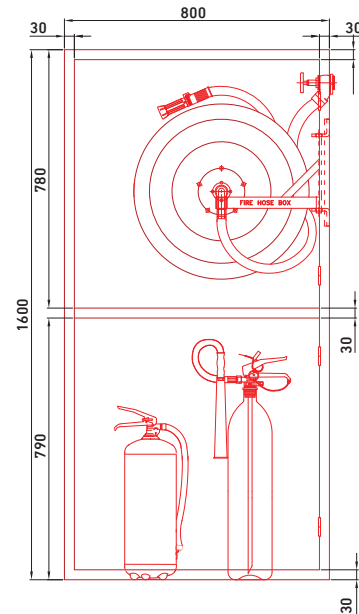

Semi Rigid Fire Hose Reel and Accessories

Fire Hose Reel

- ❖ Model : SN 20
SN 40
- ❖ Type (Standard) : Swinging Arm Type
- ❖ Type (Optional) : Fixed Type / Swinging Pipe Type
- ❖ Hose Length : 30 Mtr
- ❖ Approval : BS EN-671 / Sffeco Standard
- ❖ Swinging Angle : 180° (for Wall Mounted)
- ❖ Reel Diameter : 580mm
- ❖ Hose Color : Red (Other colors are available on request)
- ❖ Paint Finish : Electrostatic powder coat



Note: EN 671 Approved Hose Reels are provided with Plastic Nozzle and 1" Ball Valve & Nipple.

Nozzle



- ❖ Body: Brass & Chrome Plated
- ❖ 3 way control
(Jet - Spray - Shut off)

Landing Valve



- ❖ Size 1" and 1.5":
Brass body with chrome finish
- ❖ Size 2.5": Brass body
- ❖ Hand wheel made with steel and epoxy coated
- ❖ WP: 16 bar

Angle Valve



- ❖ Size 1.5": Brass body
- ❖ Hand wheel with steel epoxy coated
- ❖ UL/FM (Optional)

Plastic Nozzle

*



- ❖ 3 way control
(Jet - Spray - Shut off)

Ball Valve & Nipple

*



- ❖ Size: 1"
- ❖ Body: Chrome plated

Pressure Restricting Angle Valve



- ❖ Size 1.5": Brass body
- ❖ Hand wheel with steel epoxy coated
- ❖ UL/FM (Optional)

EN 671 Approved Hose Reels are provided with

* Plastic Nozzle (Model A) and 1" Ball Valve & Nipple.

Fire Cabinets

Design and Finish

Material and Finish

Full Stainless Steel Construction
(Door, Frame & Backbox)

- ❖ Finish : Hairline / Mirror finish
- ❖ Thickness : 0.9mm / 1mm / 1.2mm / 1.5mm / 2mm

Full Mild Steel Construction
(Door, Frame & Backbox)

- ❖ Finish : Red / as per customer request
- ❖ Thickness : 0.9mm / 1mm / 1.2mm / 1.5mm / 2mm



Backbox in Mild Steel

- ❖ Finish : Red / as per customer request
- ❖ Thickness : 0.9mm / 1mm / 1.2mm / 1.5mm / 2mm

Door and Frame in Stainless Steel

- ❖ Finish : Hairline / Mirror finish
- ❖ Thickness : 0.9mm / 1mm / 1.2mm / 1.5mm / 2mm

Trim

-  Flat Trim cabinet
-  Curved Trim cabinet

Mounting Type

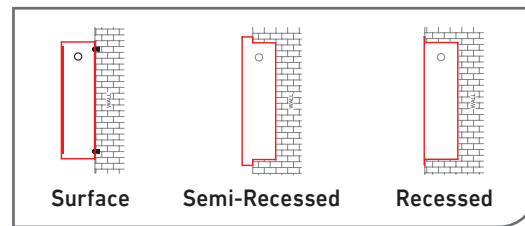

Door Opening Type

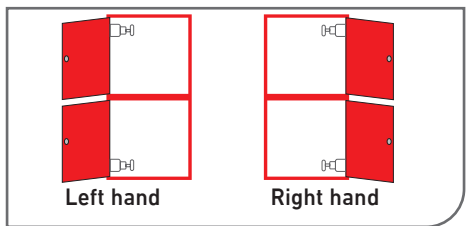

Door Selection

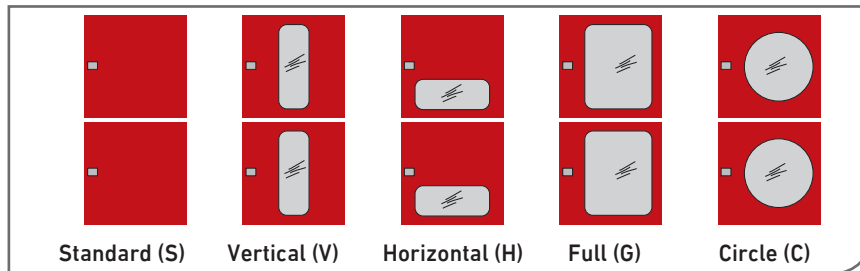

Base Type

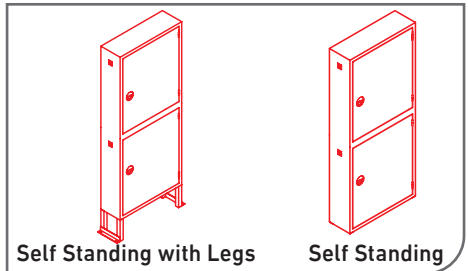

Glass Selection

